

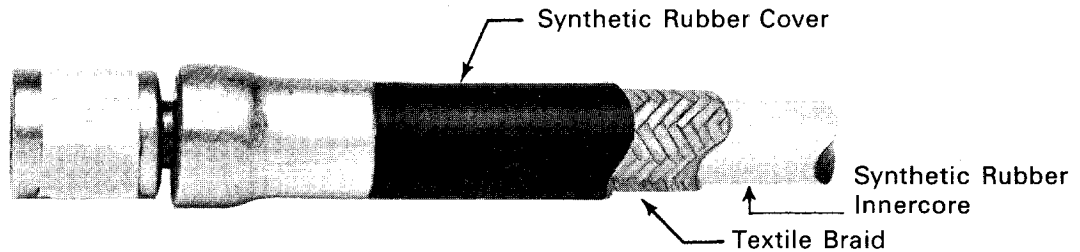

PREECE INC.
ENGINEERING
BULLETIN

RUBBER HOSE
 ASSEMBLIES LOW
 PRESSURE
 Bulletin PEB-33



APPLICATIONS AND ENGINEERING INFORMATION	<p>WORKING PRESSURE: Normal operating pressure 250 psi maximum.</p> <p>TEMPERATURE RANGE: -65°F to +160°F (-54°C to +71°C)</p> <p>APPLICATIONS: Air or vacuum instruments.</p>																																																																													
CONSTRUCTION	<p>INNERCORE: Extruded synthetic rubber</p> <p>REINFORCEMENT: Textile braid</p> <p>OUTER COVER: Synthetic Rubber</p> <p>FITTINGS: Permanently attached. CRES 304 or customer specified material. Tamper proof fittings are normally supplied to eliminate possibility of accidental loosening of fittings. Reusable fittings are available.</p>																																																																													
SPECIFICATIONS	<p>HOSE: Mil-H-5593</p>																																																																													
SPECIAL DESIGNS	<p>Preece Inc. has designed and fabricated special hose assemblies, preformed hose assemblies and specially configured end fittings for the aerospace and marine industries. For special requirements please contact the plant.</p>																																																																													
DIMENSIONS AND PRESSURE RATINGS	<table border="1"> <thead> <tr> <th rowspan="2">HOSE PART NUMBER</th> <th colspan="2">I.D. NOMINAL</th> <th colspan="2">O.D. NOMINAL</th> <th colspan="2">BEND RADIUS</th> <th colspan="2">WORKING PRESSURE</th> <th colspan="2">BURST PRESSURE</th> <th colspan="2">WEIGHT</th> </tr> <tr> <th>inches</th> <th>mm</th> <th>inches</th> <th>mm</th> <th>inches</th> <th>mm</th> <th>psi</th> <th>bar</th> <th>psi</th> <th>bar</th> <th>lbs/ft</th> <th>kg/m</th> </tr> </thead> <tbody> <tr> <td>601-04</td> <td>.250</td> <td>6.4</td> <td>.47</td> <td>11.9</td> <td>4.0</td> <td>101.6</td> <td>200</td> <td>14</td> <td>1,000</td> <td>69</td> <td>.072</td> <td>.107</td> </tr> <tr> <td>601-06</td> <td>.375</td> <td>9.5</td> <td>.59</td> <td>15.0</td> <td>4.0</td> <td>101.6</td> <td>150</td> <td>10</td> <td>600</td> <td>41</td> <td>.096</td> <td>.143</td> </tr> <tr> <td>601-08</td> <td>.500</td> <td>12.7</td> <td>.75</td> <td>19.1</td> <td>6.0</td> <td>152.4</td> <td>150</td> <td>10</td> <td>600</td> <td>41</td> <td>.144</td> <td>.214</td> </tr> <tr> <td>601-10</td> <td>.625</td> <td>15.9</td> <td>.88</td> <td>22.4</td> <td>6.0</td> <td>152.4</td> <td>150</td> <td>10</td> <td>600</td> <td>41</td> <td>.168</td> <td>.250</td> </tr> </tbody> </table>	HOSE PART NUMBER	I.D. NOMINAL		O.D. NOMINAL		BEND RADIUS		WORKING PRESSURE		BURST PRESSURE		WEIGHT		inches	mm	inches	mm	inches	mm	psi	bar	psi	bar	lbs/ft	kg/m	601-04	.250	6.4	.47	11.9	4.0	101.6	200	14	1,000	69	.072	.107	601-06	.375	9.5	.59	15.0	4.0	101.6	150	10	600	41	.096	.143	601-08	.500	12.7	.75	19.1	6.0	152.4	150	10	600	41	.144	.214	601-10	.625	15.9	.88	22.4	6.0	152.4	150	10	600	41	.168	.250
HOSE PART NUMBER	I.D. NOMINAL		O.D. NOMINAL		BEND RADIUS		WORKING PRESSURE		BURST PRESSURE		WEIGHT																																																																			
	inches	mm	inches	mm	inches	mm	psi	bar	psi	bar	lbs/ft	kg/m																																																																		
601-04	.250	6.4	.47	11.9	4.0	101.6	200	14	1,000	69	.072	.107																																																																		
601-06	.375	9.5	.59	15.0	4.0	101.6	150	10	600	41	.096	.143																																																																		
601-08	.500	12.7	.75	19.1	6.0	152.4	150	10	600	41	.144	.214																																																																		
601-10	.625	15.9	.88	22.4	6.0	152.4	150	10	600	41	.168	.250																																																																		

HOSE ASSEMBLY NUMBERING SYSTEM

Example 1

STRAIGHT TO STRAIGHT FITTING

ASSEMBLIES WITH STRAIGHT FITTINGS EACH END USE DASH SIZE DESIGNATION.

601000 8C 0145

BASIC ASSEMBLY NO. _____ ASSEMBLY LENGTH 14 5/8" LAST DIGIT IN 1/8 INCH INCREMENTS

SIZE (1/2" OD Tube Size) _____ FITTING MATERIAL DESIGNATION

Example 2

STRAIGHT TO 90° ELBOW FITTING

ASSEMBLIES WITH ELBOW FITTING ONE END AND STRAIGHT FITTING ONE END USE DASH SIZE DESIGNATION.

601007 4D 0134

BASIC ASSEMBLY NO. _____ ASSEMBLY LENGTH 13 1/2" LAST DIGIT IN 1/8 INCH INCREMENTS

SIZE (1/4" OD Tube Size) _____ FITTING MATERIAL DESIGNATION

Example 3

90° ELBOW TO 90° ELBOW FITTING

ASSEMBLIES WITH ELBOWS EACH END USE LETTER CODE FOR SIZE DESIGNATION

601003 F 0173 C 090

BASIC ASSEMBLY NO. _____ ANGULAR ROTATION IN DEGREES (MEASURED COUNTER CLOCKWISE)

SIZE (1/4" Tube Size) _____ FITTING MATERIAL DESIGNATION

_____ ASSEMBLY LENGTH 17 3/8" LAST DIGIT IN 1/8 INCH INCREMENTS

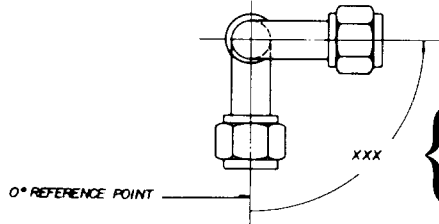

ANGULAR ROTATION IN DEGREES MEASURED COUNTERCLOCKWISE WHEN USING ELBOW CONFIGURATIONS ON BOTH ENDS

TUBE SIZE (O.D.)	1/4"	3/8"	1/2"	3/4"
DASH SIZE	-4	-6	-8	-10
LETTER CODE	F	H	J	K

FITTING MATERIAL DESIGNATION

C = Stainless (CRES 304)
 A = Stainless (CRES 316)
 D = Aluminum
 M = Monel QQ-N-281
 P = Copper Nickel

BASIC HOSE ASSEMBLY PART NO.	DESCRIPTION		FITTING A	FITTING B	ASSEMBLY LENGTH	BASIC HOSE ASSEMBLY PART NO.	DESCRIPTION		FITTING A	FITTING B	ASSEMBLY LENGTH
	FITTING A	FITTING B					FITTING A	FITTING B			
601000	STRAIGHT SWIVEL, AN CONNECTION	STRAIGHT SWIVEL, AN CONNECTION			---	601006	STRAIGHT SWIVEL, FLARELESS CONNECTION	STRAIGHT SWIVEL, FLARELESS CONNECTION			---
601001	STRAIGHT SWIVEL, AN CONNECTION	90° SWIVEL, AN CONNECTION			---	601007	STRAIGHT SWIVEL, FLARELESS CONNECTION	90° SWIVEL, FLARELESS CONNECTION			---
601002	STRAIGHT SWIVEL, AN CONNECTION	45° SWIVEL, AN CONNECTION			---	601008	STRAIGHT SWIVEL, FLARELESS CONNECTION	45° SWIVEL, FLARELESS CONNECTION			---
601003	90° SWIVEL, AN CONNECTION	90° SWIVEL, AN CONNECTION			---	601009	90° SWIVEL, FLARELESS CONNECTION	90° SWIVEL, FLARELESS CONNECTION			---
601004	45° SWIVEL, AN CONNECTION	45° SWIVEL, AN CONNECTION			---	601010	45° SWIVEL, FLARELESS CONNECTION	45° SWIVEL, FLARELESS CONNECTION			---
601005	90° SWIVEL, AN CONNECTION	45° SWIVEL, AN CONNECTION			---	601011	90° SWIVEL, FLARELESS CONNECTION	45° SWIVEL, FLARELESS CONNECTION			---



PREECE INC.
ENGINEERING
BULLETIN

RUBBER HOSE
ASSEMBLIES MEDIUM
PRESSURE

Bulletin PEB-34

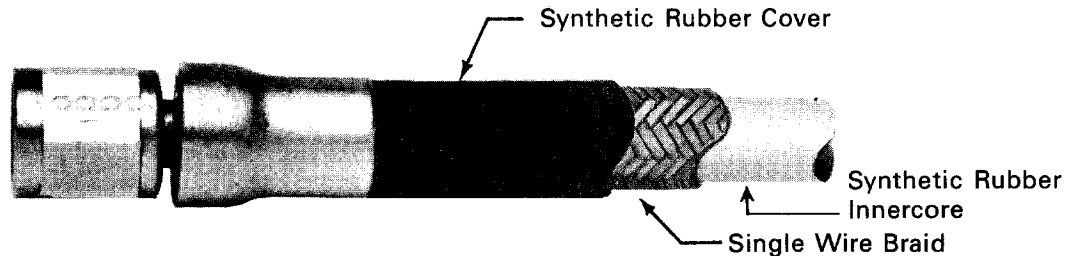

APPLICATIONS AND ENGINEERING INFORMATION	<p>WORKING PRESSURE: Normal operating pressure 3000 psi maximum.</p> <p>TEMPERATURE RANGE: -65°F to +250°F (-54°C to +121°C)</p> <p>APPLICATIONS: Hydraulic, lubrication, pneumatic and fuel.</p>																																																																																																																				
CONSTRUCTION	<p>INNERCORE: Extruded synthetic rubber</p> <p>REINFORCEMENT: Single wire braid of carbon steel</p> <p>OUTER COVER: Synthetic Rubber</p> <p>FITTINGS: Permanently attached. CRES 304 or customer specified material. Tamper proof fittings are normally supplied to eliminate possibility of accidental loosening of fittings. Reusable fittings are available.</p>																																																																																																																				
SPECIFICATIONS	<p>HOSE: Mil-H-8794</p>																																																																																																																				
SPECIAL DESIGNS	<p>Preece Inc. has designed and fabricated special hose assemblies, preformed hose assemblies and specially configured end fittings for the aerospace and marine industries. For special requirements please contact the plant.</p>																																																																																																																				
DIMENSIONS AND PRESSURE RATINGS	<table border="1"> <thead> <tr> <th rowspan="2">HOSE PART NUMBER</th> <th colspan="2">I.D. NOMINAL</th> <th colspan="2">O.D. NOMINAL</th> <th colspan="2">BEND RADIUS</th> <th colspan="2">WORKING PRESSURE</th> <th colspan="2">BURST PRESSURE</th> <th colspan="2">WEIGHT</th> </tr> <tr> <th>inches</th> <th>mm</th> <th>inches</th> <th>mm</th> <th>inches</th> <th>mm</th> <th>psi</th> <th>bar</th> <th>psi</th> <th>bar</th> <th>lbs/ft</th> <th>kg/m</th> </tr> </thead> <tbody> <tr> <td>602-04</td> <td>.187</td> <td>4.8</td> <td>.52</td> <td>13.2</td> <td>3.0</td> <td>76.6</td> <td>3000</td> <td>207</td> <td>12,000</td> <td>828</td> <td>.132</td> <td>.196</td> </tr> <tr> <td>602-05</td> <td>.250</td> <td>6.4</td> <td>.58</td> <td>14.7</td> <td>3.4</td> <td>86.4</td> <td>2500</td> <td>173</td> <td>10,000</td> <td>690</td> <td>.156</td> <td>.232</td> </tr> <tr> <td>602-06</td> <td>.312</td> <td>7.9</td> <td>.67</td> <td>17.0</td> <td>4.0</td> <td>111.8</td> <td>2000</td> <td>138</td> <td>9,000</td> <td>621</td> <td>.228</td> <td>.339</td> </tr> <tr> <td>602-08</td> <td>.406</td> <td>10.3</td> <td>.77</td> <td>19.6</td> <td>4.6</td> <td>116.8</td> <td>2000</td> <td>138</td> <td>8,000</td> <td>552</td> <td>.264</td> <td>.393</td> </tr> <tr> <td>602-10</td> <td>.500</td> <td>12.7</td> <td>.92</td> <td>23.4</td> <td>5.5</td> <td>139.7</td> <td>1750</td> <td>121</td> <td>7,000</td> <td>483</td> <td>.372</td> <td>.554</td> </tr> <tr> <td>602-12</td> <td>.625</td> <td>15.9</td> <td>1.07</td> <td>27.2</td> <td>6.5</td> <td>165.1</td> <td>1500</td> <td>104</td> <td>6,000</td> <td>414</td> <td>.456</td> <td>.679</td> </tr> <tr> <td>602-16</td> <td>.875</td> <td>22.2</td> <td>1.23</td> <td>31.2</td> <td>7.4</td> <td>188.0</td> <td>800</td> <td>55</td> <td>3,200</td> <td>221</td> <td>.444</td> <td>.661</td> </tr> </tbody> </table>	HOSE PART NUMBER	I.D. NOMINAL		O.D. NOMINAL		BEND RADIUS		WORKING PRESSURE		BURST PRESSURE		WEIGHT		inches	mm	inches	mm	inches	mm	psi	bar	psi	bar	lbs/ft	kg/m	602-04	.187	4.8	.52	13.2	3.0	76.6	3000	207	12,000	828	.132	.196	602-05	.250	6.4	.58	14.7	3.4	86.4	2500	173	10,000	690	.156	.232	602-06	.312	7.9	.67	17.0	4.0	111.8	2000	138	9,000	621	.228	.339	602-08	.406	10.3	.77	19.6	4.6	116.8	2000	138	8,000	552	.264	.393	602-10	.500	12.7	.92	23.4	5.5	139.7	1750	121	7,000	483	.372	.554	602-12	.625	15.9	1.07	27.2	6.5	165.1	1500	104	6,000	414	.456	.679	602-16	.875	22.2	1.23	31.2	7.4	188.0	800	55	3,200	221	.444	.661
HOSE PART NUMBER	I.D. NOMINAL		O.D. NOMINAL		BEND RADIUS		WORKING PRESSURE		BURST PRESSURE		WEIGHT																																																																																																										
	inches	mm	inches	mm	inches	mm	psi	bar	psi	bar	lbs/ft	kg/m																																																																																																									
602-04	.187	4.8	.52	13.2	3.0	76.6	3000	207	12,000	828	.132	.196																																																																																																									
602-05	.250	6.4	.58	14.7	3.4	86.4	2500	173	10,000	690	.156	.232																																																																																																									
602-06	.312	7.9	.67	17.0	4.0	111.8	2000	138	9,000	621	.228	.339																																																																																																									
602-08	.406	10.3	.77	19.6	4.6	116.8	2000	138	8,000	552	.264	.393																																																																																																									
602-10	.500	12.7	.92	23.4	5.5	139.7	1750	121	7,000	483	.372	.554																																																																																																									
602-12	.625	15.9	1.07	27.2	6.5	165.1	1500	104	6,000	414	.456	.679																																																																																																									
602-16	.875	22.2	1.23	31.2	7.4	188.0	800	55	3,200	221	.444	.661																																																																																																									

HOSE ASSEMBLY NUMBERING SYSTEM

Example 1

STRAIGHT TO STRAIGHT FITTING

ASSEMBLIES WITH STRAIGHT FITTINGS EACH END USE DASH SIZE DESIGNATION.

602000 8C 0145

BASIC ASSEMBLY NO. _____ ASSEMBLY LENGTH 14½" LAST DIGIT IN ½ INCH INCREMENTS
 SIZE (½" OD Tube Size) _____ FITTING MATERIAL DESIGNATION

Example 2

STRAIGHT TO 90° ELBOW FITTING

ASSEMBLIES WITH ELBOW FITTING ONE END AND STRAIGHT FITTING ONE END USE DASH SIZE DESIGNATION.

602007 4D 0134

BASIC ASSEMBLY NO. _____ ASSEMBLY LENGTH 13½" LAST DIGIT IN ½ INCH INCREMENTS
 SIZE (¼" OD Tube Size) _____ FITTING MATERIAL DESIGNATION

Example 3

90° ELBOW TO 90° ELBOW FITTING

ASSEMBLIES WITH ELBOWS EACH END USE LETTER CODE FOR SIZE DESIGNATION

602003 F 0173 C 090

BASIC ASSEMBLY NO. _____ ANGULAR ROTATION IN DEGREES (MEASURED COUNTER CLOCKWISE)
 SIZE (¼" Tube Size) _____ FITTING MATERIAL DESIGNATION
 _____ ASSEMBLY LENGTH 17¾" LAST DIGIT IN ½ INCH INCREMENTS

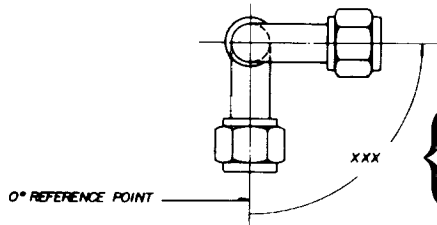

ANGULAR ROTATION IN DEGREES MEASURED COUNTERCLOCKWISE WHEN USING ELBOW CONFIGURATIONS ON BOTH ENDS

TUBE SIZE (O.D.)	1/4"	5/16"	3/8"	1/2"	5/8"	3/4"	1"
DASH SIZE	-4	-5	-6	-8	-10	-12	-16
LETTER CODE	F	G	H	J	K	L	M

FITTING MATERIAL DESIGNATION
C = Stainless (CRES 304)
A = Stainless (CRES 316)
D = Aluminum
M = Monel QQ-N-281
P = Copper Nickel

BASIC HOSE ASSEMBLY PART NO.	DESCRIPTION		FITTING A	FITTING B	ASSEMBLY LENGTH	BASIC HOSE ASSEMBLY PART NO.	DESCRIPTION		FITTING A	FITTING B	ASSEMBLY LENGTH
	FITTING A	FITTING B					FITTING A	FITTING B			
602000	STRAIGHT SWIVEL, AN CONNECTION	STRAIGHT SWIVEL, AN CONNECTION				602006	STRAIGHT SWIVEL, FLARELESS CONNECTION	STRAIGHT SWIVEL, FLARELESS CONNECTION			
602001	STRAIGHT SWIVEL, AN CONNECTION	90° SWIVEL, AN CONNECTION				602007	STRAIGHT SWIVEL, FLARELESS CONNECTION	90° SWIVEL, FLARELESS CONNECTION			
602002	STRAIGHT SWIVEL, AN CONNECTION	45° SWIVEL, AN CONNECTION				602008	STRAIGHT SWIVEL, FLARELESS CONNECTION	45° SWIVEL, FLARELESS CONNECTION			
602003	90° SWIVEL, AN CONNECTION	90° SWIVEL, AN CONNECTION				602009	90° SWIVEL, FLARELESS CONNECTION	90° SWIVEL, FLARELESS CONNECTION			
602004	45° SWIVEL, AN CONNECTION	45° SWIVEL, AN CONNECTION				602010	45° SWIVEL, FLARELESS CONNECTION	45° SWIVEL, FLARELESS CONNECTION			
602005	90° SWIVEL, AN CONNECTION	45° SWIVEL, AN CONNECTION				602011	90° SWIVEL, FLARELESS CONNECTION	45° SWIVEL, FLARELESS CONNECTION			